

CANADIAN PECULIAR

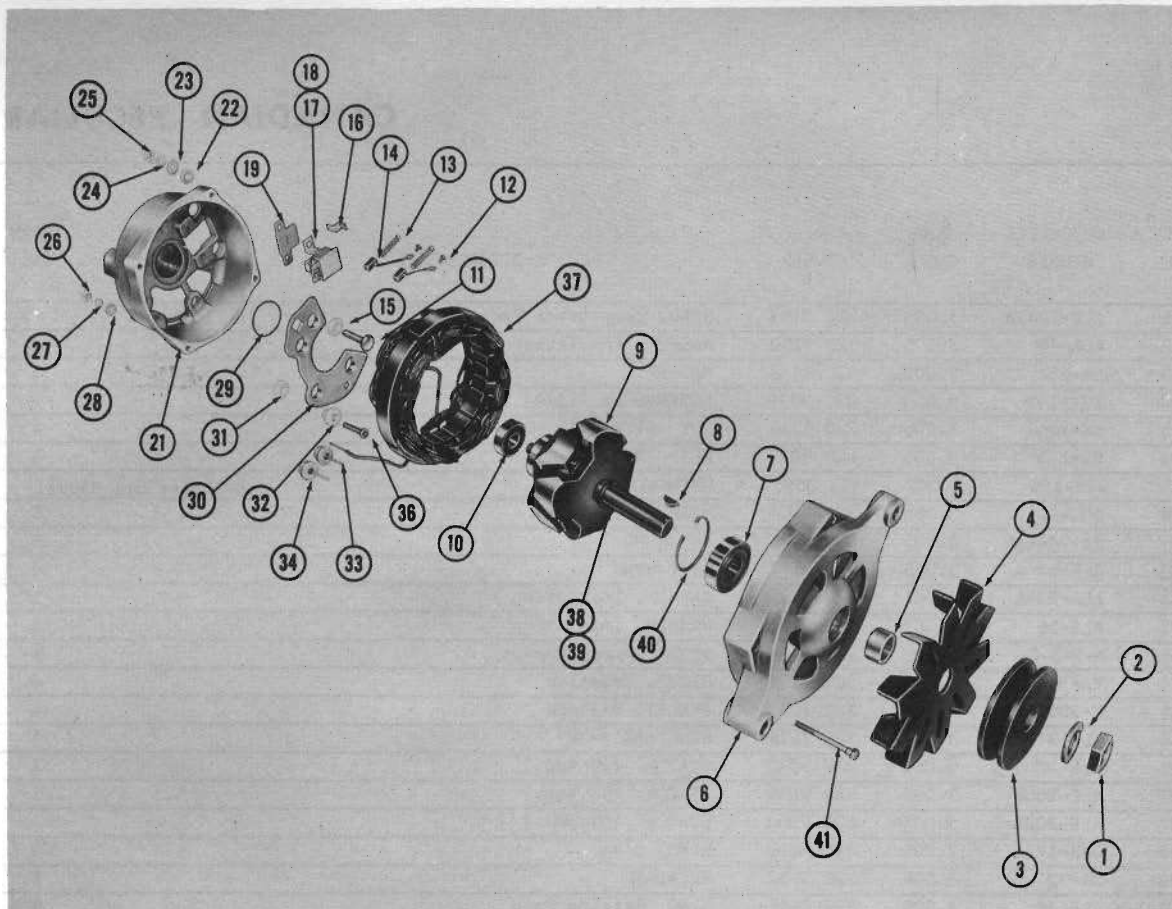

ALTERNATOR 165 01-10 (OHV-199): 165 01-10-80 (OHV-232)

A.M. NO. 317 8915 (34 Amp.)
 A.M. NO. 318 0083 (40 Amp.)
 A.M. NO. 318 0074 (55 Amp.)

AUTO-LITE NO. ALK-6402
 AUTO-LITE NO. ALE-6009
 AUTO-LITE NO. OE-6002

KEY NO.	AUTO-LITE NUMBER	A.M. GROUP	A.M. PART NUMBER	DESCRIPTION	QUAN. REQ.
1	GBM-21B	3.010	311 2796	NUT, Rotor Shaft Drive End (Replaces 311 8776)	1
2	L2X-864	3.010	311 8777	LOCKWASHER, Rotor Shaft Drive End Nut	1
3	PU-585	3.010	320 9013	PULLEY, Drive	1
4	PU-625	3.010	320 9014	FAN, Ventilating (34 Amp.)	1
4	PU-1664	3.010	320 9174	FAN, Ventilating (40 Amp.)(55 Amp.)	1
5	ALC-21-D	3.005	320 9031	SPACER, Rotor Shaft	1
6	ALK-25	3.005	320 9140	HEAD, Drive End	1
7	X-3416	3.005	320 9016	BEARING, Ball	1
8	X-261	3.010	320 3643	KEY, Woodruff (#6)	1
9	ALK-2024	3.005	320 9146	ROTOR ASSEMBLY (34 Amp.)	1
9	ALE-2046	3.005	320 9175	ROTOR ASSEMBLY (40 Amp.)	1
9	ALH-2046	3.005	320 9176	ROTOR ASSEMBLY (55 Amp.)	1
10	X-3433	3.005	320 9148	BEARING, Ball	1
11	8X-3550	3.005	320 9152	TERMINAL STUD	1
12	8X-3611	3.005	320 9145	SCREW, Brush Holder (#4-40)	2
13	ALA-19	3.005	320 9033	SPRING, Brush	2
14	ALE-1012-KS	3.005	320 9161	BRUSH SET	1
16	ALA-33	3.005	320 9037	WASHER, Insulation	1
16	ALE-48	3.005	320 9144	TERMINAL SPADE	1
17	ALE-45	3.005	320 9142	BRACKET, Brush	1
18	ALE-41	3.005	320 9143	HOLDER, Brush	1
19	ALE-55			INSULATION	1
20	X-3470	3.005	320 9021	SCREW (#10-24)	2